

ALANTRA

Quality and Service



Request your free quote today!

Eastern Canada's Leader in Job Site Trailers and Modular Buildings



- OFFICES
- LUNCHROOMS
- BUNKHOUSES (MULTI-LAYOUTS)
- SELF-CONTAINED WASHROOMS
- WASHROOM UNITS
- SHOWER UNITS
- CHANGING ROOMS
- LOCKER ROOMS
- WATER/SEPTIC SKIDS
- SECURITY TRAILERS
- STORAGE CONTAINERS
- REMOTE WELL-SITE TRAILERS
- OFFICE COMPLEXES
- MODULAR BUILDINGS
- MINING & CONSTRUCTION CAMPS
- PREFABRICATED WALL, FLOOR, & ROOF PANELS
- DAYCARES
- CLASSROOMS
- NON-COMBUSTIBLE UNITS



If we don't have it, we'll build it.

New Brunswick | Newfoundland and Labrador | Nova Scotia | Nunavut | Ontario | Prince Edward Island | Quebec

Scan the QR code to check our products online.

1-800-456-1800
www.alantraleasing.com

SEE REVERSE FOR THE FULL PRODUCT RENTAL LIST

Open Office | Lunch Room

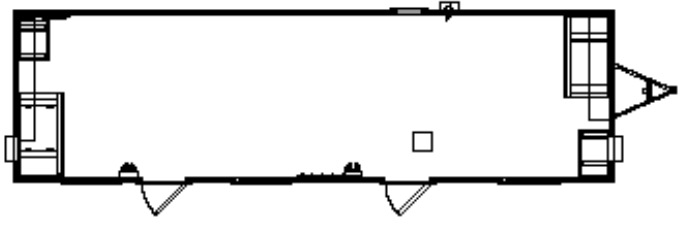

Sizes: 20x10, 30x10, 40x10, 40x12, 50x12, 60x12

Two Office

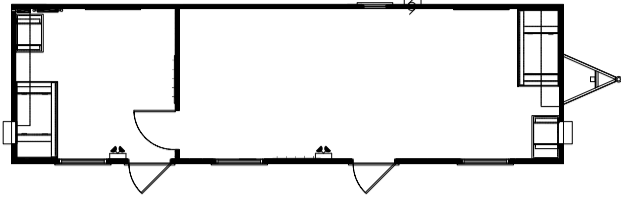

Sizes: 30x10, 40x10, 40x12, 50x12, 60x12

Three Office

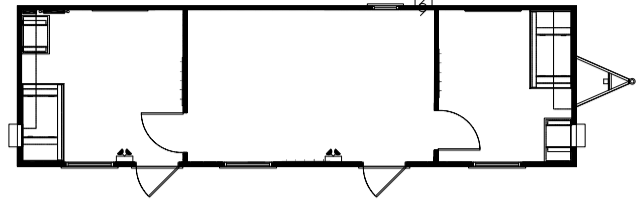

Sizes: 40x10, 40x12, 50x12, 60x12

Open Two or Three Office & 1/2 Bath

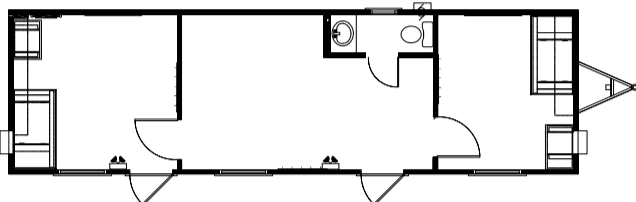

Sizes: 40x10, 40x12, 50x12, 60x12

Four Offices, 1/2 Bath & Kitchenette

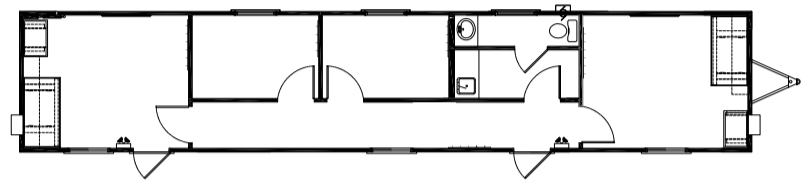

Size: 60x12

Offices & Self-Contained Washroom

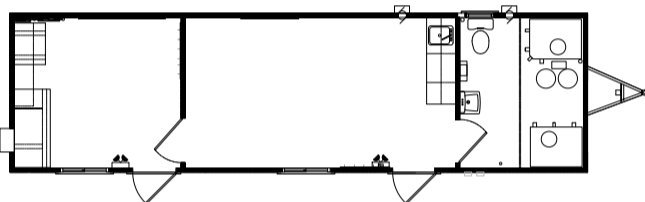

Sizes: 40x11, 60x11

Five Office

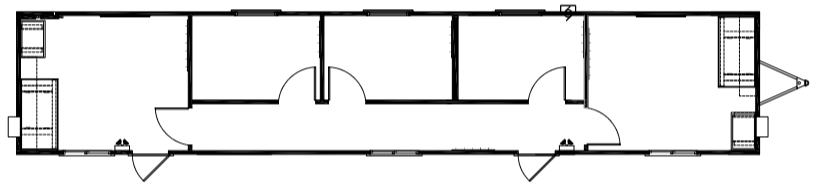

Size: 60x12

Self-Contained Washrooms

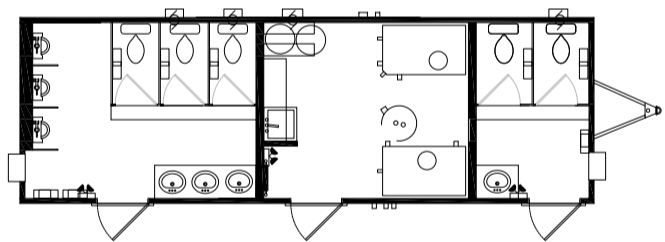
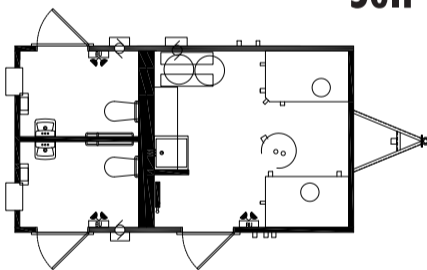

Sizes: 20x11, 34x11, 60x11

Shower Trailer

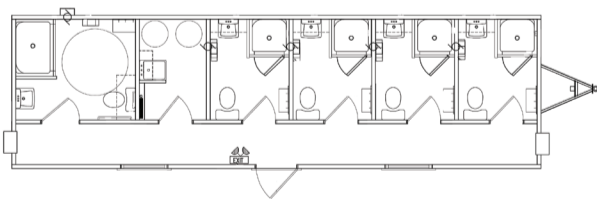

Sizes: 40x12

Locker Room

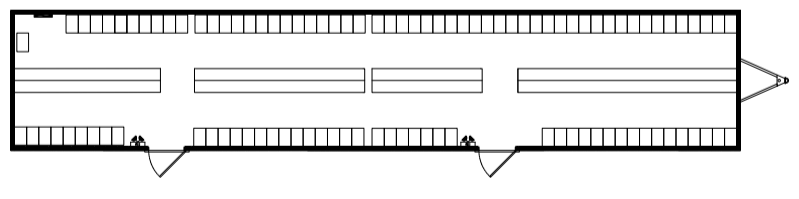

Sizes: 20x12, 40x12, 60x12

3-Person Bunkhouse

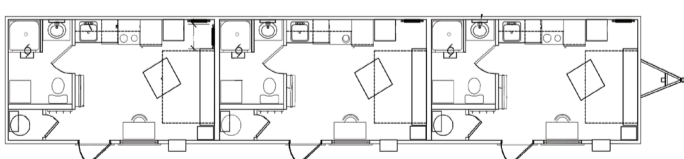

Size: 60x12

5-Person Bunkhouse

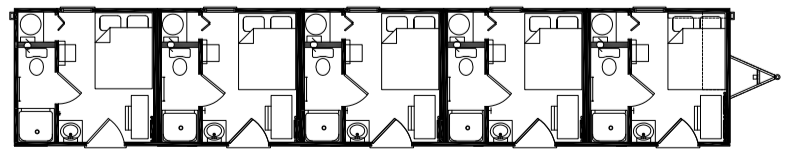

Size: 60x12

ALANTRA

Qualité et service



Demandez votre soumission gratuite dès aujourd'hui!

Le chef de file de l'est du Canada en matière de roulottes de chantier et de bâtiments modulaires



- BUREAUX
- SALLE À MANGER
- DORTOIRS (DIFFÉRENTS MODÈLES)
- TOILETTES AUTONOMES
- ROULOTTES SANITAIRES
- ROULOTTES DE DOUCHE
- VESTIAIRES AVEC CASIERS
- RÉSERVOIRS D'EAU PROPRE/USÉES DE TYPE ROLL OFF
- GUÉRITE DE SÉCURITÉ
- CONTENEURS DE STOCKAGE
- ROULOTTE POUR SITE DE FORAGE
- COMPLEXE DE BUREAUX
- BÂTIMENTS MODULAIRES
- CAMPS MINIER
- PANNEAUX PRÉFABRIQUÉS
- GARDERIES
- SALLES DE CLASSE
- UNITÉS INCOMBUSTIBLES



Nouveau-Brunswick | Terre-Neuve-et-Labrador | Nouvelle-Écosse | Nunavut | Ontario | Île-du-Prince-Édouard | Québec

VOIR AU VERSO POUR LA LISTE COMPLÈTE DES PRODUITS DE LOCATION

Scannez le code QR pour consulter nos produits en ligne.



1-800-456-1800
www.alantraleasing.com

Bureau ouvert | Salle à manger

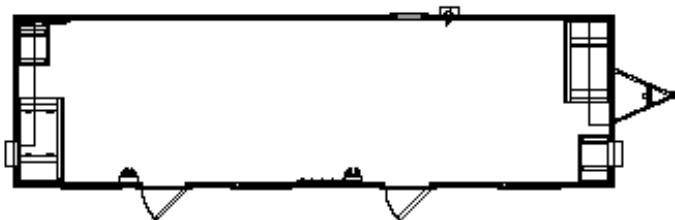

Tailles: 20x10, 30x10, 40x10, 40x12, 50x12, 60x12

Une division

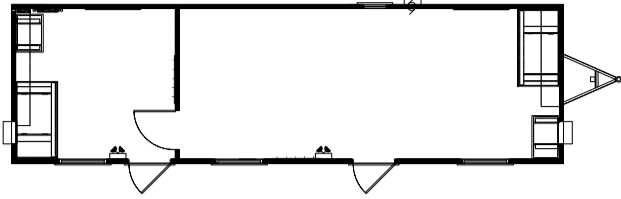

Tailles: 30x10, 40x10, 40x12, 50x12, 60x12

Deux divisions

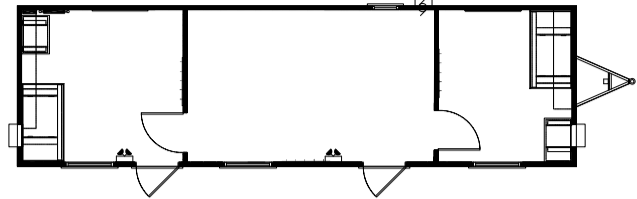

Tailles: 40x10, 40x12, 50x12, 60x12

Bureaux avec salle d'eau

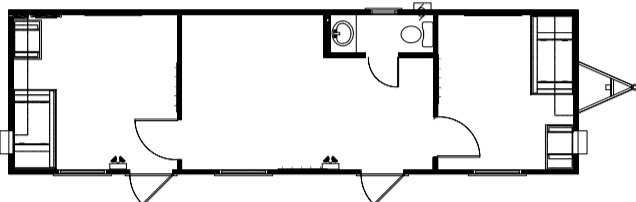

Tailles: 40x10, 40x12, 50x12, 60x12

Quatre bureaux, salle d'eau, cuisinette

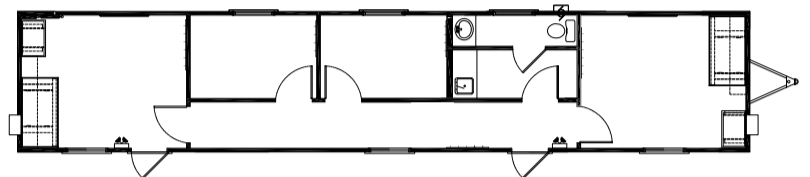

Tailles: 60x12

Bureaux - toilettes autonomes

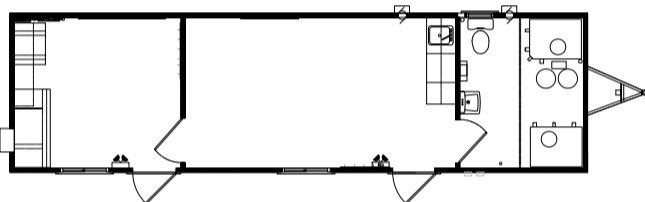

Tailles: 40x11, 60x11

Cinq bureaux

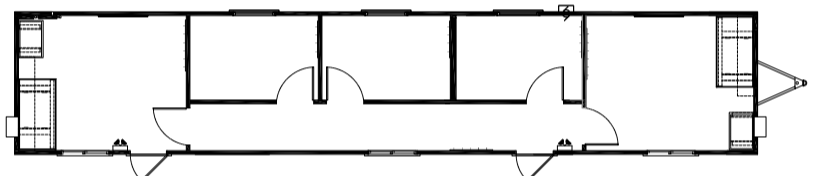

Tailles: 60x12

Toilettes autonomes

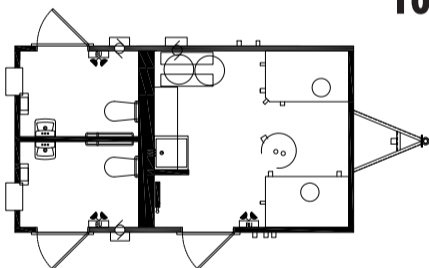

Tailles: 20x11, 34x11, 60x11

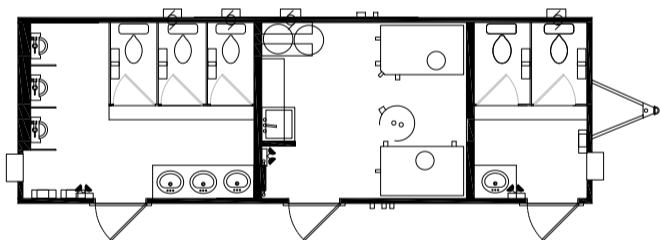

Roulotte de douche

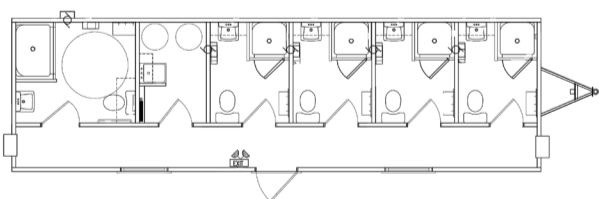

Tailles: 40x12

Vestiaires

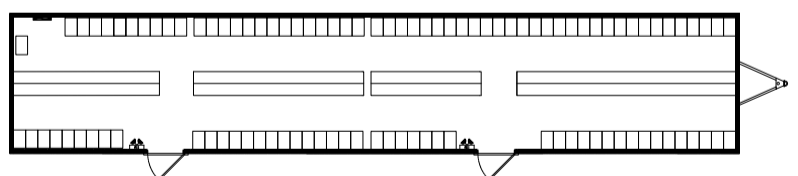

Tailles: 20x12, 40x12, 60x12

Dortoir-3 personnes

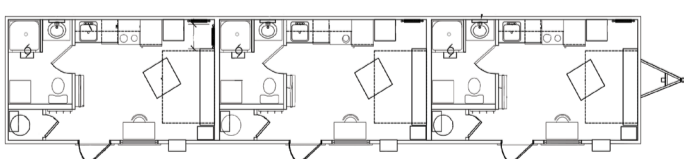

Tailles: 60x12

Dortoir-5 personnes

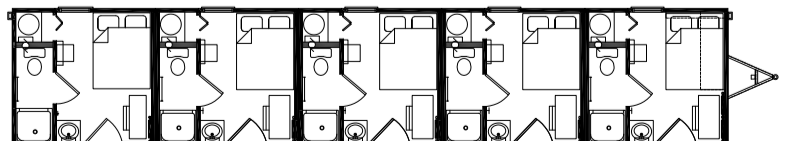

Tailles: 60x12